

ProLine Drying Cabinet FC 20

Installation and operation manual



Warning! Use safety glasses
when building this equipment.



Do not use this appliance until you
have read these instructions!

Contents

Safety regulations	5
Specification	6
Dimensions	6
Technical information	7
Assembly instructions	8
Installation of the cabinet	19
Step 1: Put the cabinet in place	19
Step 2: Fasten the cabinet to the wall	19
Step 3: Connect the cabinet to the ventilation channel	19
Step 4: Connect the drying cabinet to the main switch/breaker	20
Step 5: Control that the heating relay is working	20
Requirements for ventilation	21
Ventilation channel – choice of material	21
Requirements for incoming air	21
Ventilation channel – design	21
Evacuated amount of air and pressure fall	22
User manual	23
Automatic programs	23
Select drying time manually	23
Maintenance	24
Take good care of the cabinet	24
Ventilation system	24
Keep your cabinet efficient and economical	24
Warranty	25
Notes	26-27

Dear Customer

We are pleased that you have chosen our drying cabinet.

Your new drying cabinet is the result of many years of development work. The highest quality requirements, both in development and manufacture.

Its design meets all the demands of modern laundry care and offers you a varied and individual choice of programs.

Sparing use of energy and short drying times help to ensure that you can use your drying cabinet as economically as possible.

Please read these instructions carefully to enable you to use all the possibilities and advantages of your new drying cabinet. Please note in particular the safety informations.

We hope you will be very happy with your new drying cabinet.

IMPORTANT!

FOR YOUR SAFETY, the information in this manual must be followed to prevent property damage and personal injury.

NOTE: The paragraphs marked "WARNING" and "CAUTION" appearing in this manual are not meant to cover all possible conditions and situations that may occur. It is very important that water and electricity are handled with great care and respect, by both installation technicians and end users.

Safety regulations

Throughout this manual you will find text warnings in text boxes: "WARNING" and "CAUTION". In these boxes you'll find the safety measurements you'll have to take; end user, service staff or installation staff.

CAUTION

Indicates hazardous situation that, if not avoided, could cause minor personal injury or property damage.

WARNING

Indicates hazardous situation that, if not avoided, could cause severe personal injury.

You will also find precautions marked: IMPORTANT and NOTE. These are followed by information of what should be considered.

IMPORTANT: to inform the reader of special steps that must be taken in order to prevent injuries on the cabinet.

NOTE: to inform what is important to know, but it cannot cause personal injuries or injury on the cabinet.

WARNING

To minimize the risk of fire, electrical shock, personal injuries or death when the cabinet is in use the following precautions must be followed:

1. Read the instruction before using the drying cabinet.
2. Follow the installation instructions for proper grounding.
3. Never dry textiles that have been washed, dipped or exposed to fire dangerous substances or fluids.
4. Never add fire dangerous or explosives substances to the cabinet.
5. The cabinet is not a toy. Look after children who are around the cabinet.
6. Never connect the cabinet with an extension cable.
7. Only use the cabinet for what it is designed for: drying clothes.
8. Always turn off the main switch before performing any service on the cabinet. Only authorized service technicians should perform service.
9. Always follow the installation manual. The electrical connections must be installed by authorized personnel.
10. Keep after the cabinet. If it is exposed to violence there is a risk that certain security functions will stop working. Please contact your nearest service partner if you are unsure of the cabinet's status.
11. If the electrical cable is damaged, it must immediately be changed by a person with electrical authorization.
12. The doors shall always be shut when the cabinet is in use. Do not try to manipulate the lock of the doors. It can lead to personal injuries. If the cabinet does not stop when the doors are opened during the drying phase, call for service. The cabinet shall not be used if the drying program is active when the doors are open!
13. Look after the area around the evacuating pipe so it is clean from dust and dirt.
14. To get the best drying result, follow the garments washing and drying advice.
15. Never use the cabinet if any panel is broken or removed.
16. Never use the cabinet if any parts are broken or if the inside is broken.
17. Never try to manipulate or connect past any safety functions.
18. If the cabinet is not assembled after the manufacturer's instructions, there is a risk that the cabinet can cause personal injuries or injuries on property.

Specification

Dimensions

Measurements shown in millimeter (mm).

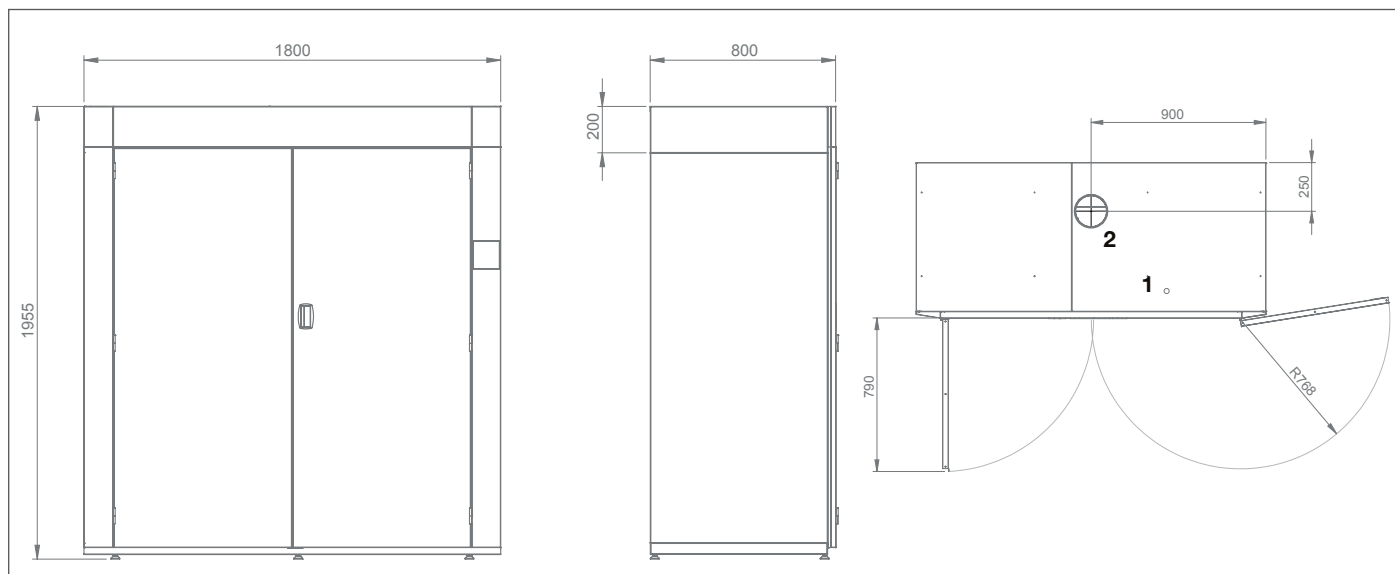

- 1. Electrical connection
- 2. Outlet exhaust

Technical Information

Machine type		Drying cabinet	
Product No. 3P electrical connection		232001	
Product No. 1P electrical connection		232004	
Warranty		3 years limited	
Color		Grey	
Mail data			
Type		Air vented	
Capacity, sets of suits/overalls	#	6	
Capacity (dry weight)	lb/kg	55/25	
Interior capacity	cu ft/L	73,1/2070	
Drying capacity	oz/min	2	
Drying capacity	g/min	55	
Energy consumption	kWh	6.7	
Noise emission	dB(A)	65	
Electrical connection 3P			
Supply voltage	V	208 V, 3P, 60Hz	240 V, 3P, 60Hz
Electric heating	W	9000	12000
Electric fan	W	450	525
Total effect	W	9450	12525
Protection	A	40	40
Electrical connection 1P			
Supply voltage	V	240 V, 1P, 60Hz	
Electric heating	W	9000	
Electric fan	W	525	
Total effect	W	9525	
Protection	A	60	
Dimensions			
Outer: width x depth x height	in/mm	71 x 31.5 x 77/1800 x 800 x 1955	
Shipping outer: width x depth x height	in/mm	75 x 31 x 42/1915 x 790 x 1060	
Weight			
Weight	lb/kg	≈441/200	
Shipping weight	lb/kg	≈528/240	
Ventilation			
Outlet exhaust	Ø in/mm	6/152	
Outlet airflow	cfm/m³/h	210/350	
Pressure drop, max	psf/Pa	4.4/210	
Maximum airflow (at 0% pressure)	cfm/m³/h	383/650	

Assembly instructions

Tools

You need the following tools to easily install the drying cabinet, :

- Cordless screwdriver
- Wrench
- Hex key 3 and 5 mm
- Level
- Torx screwdriver bit no. 25

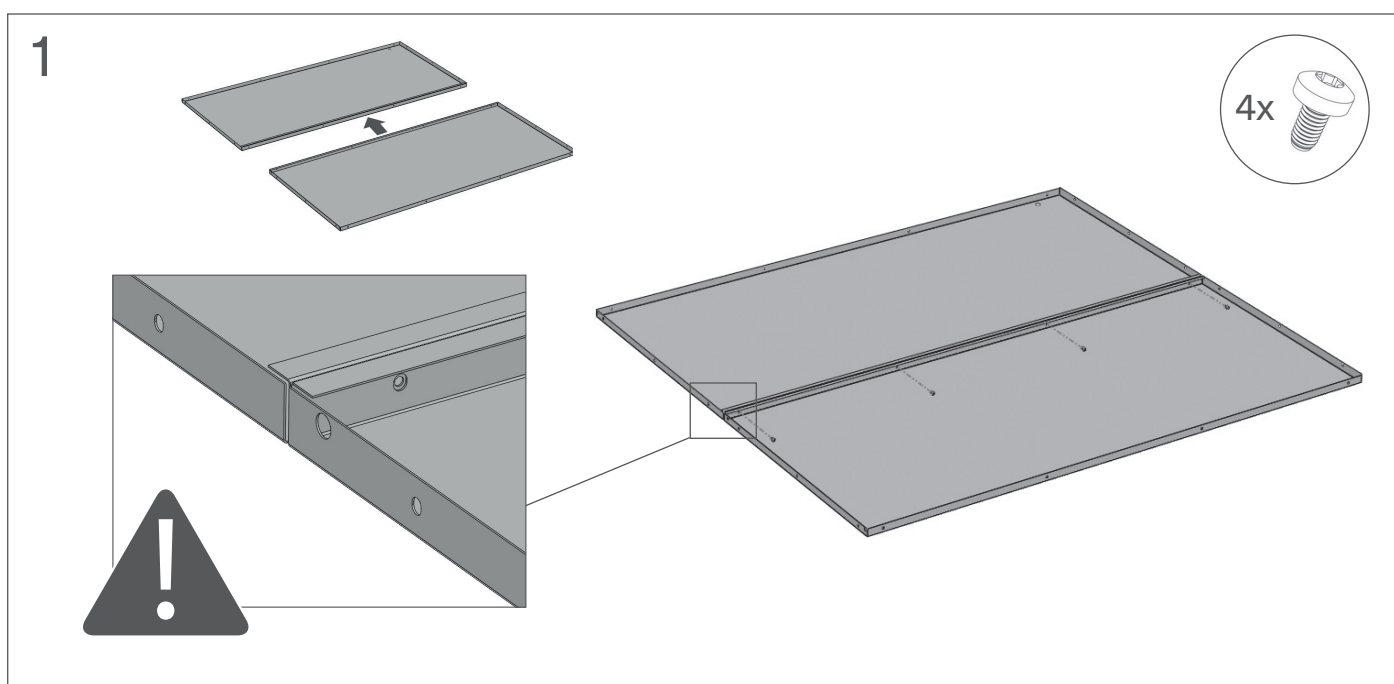
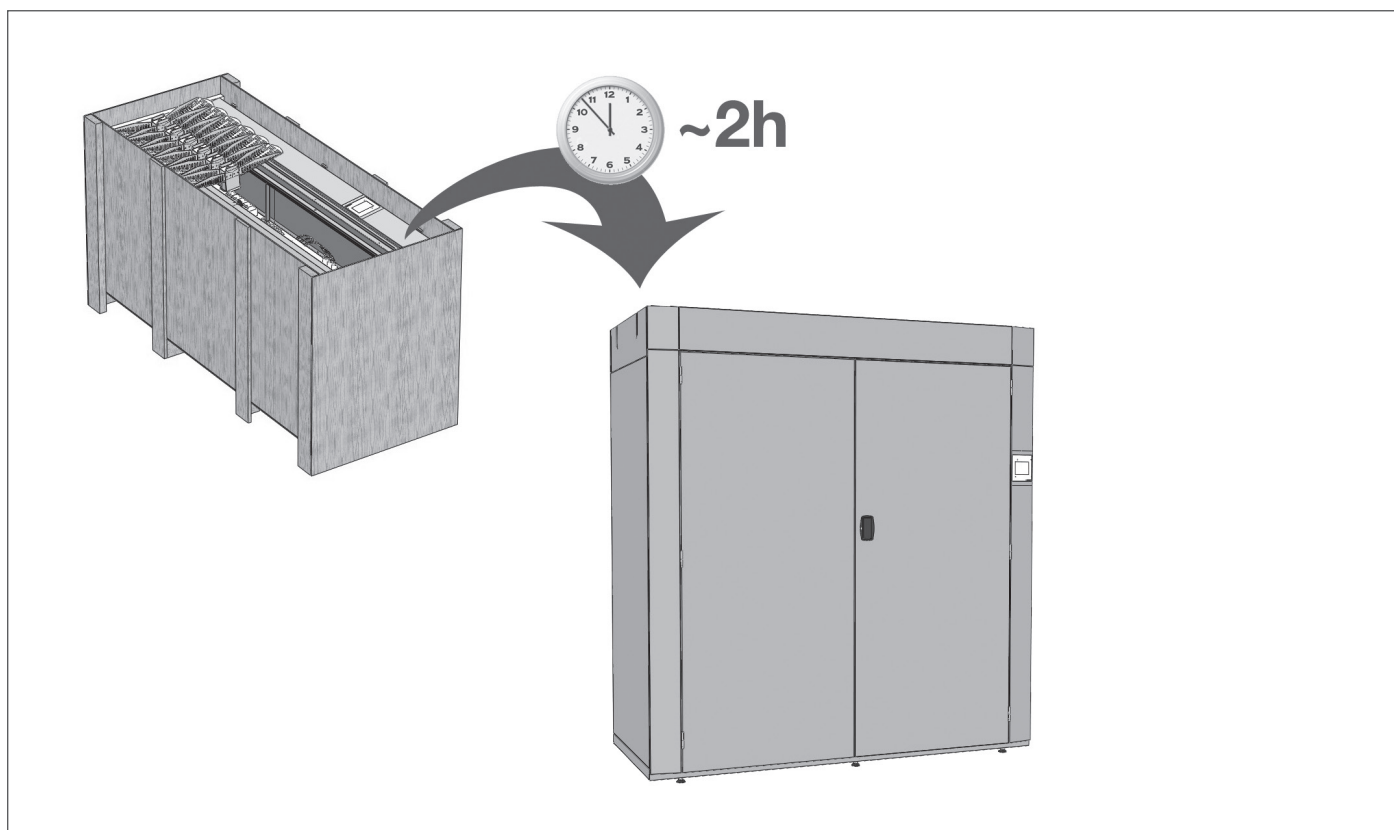

2

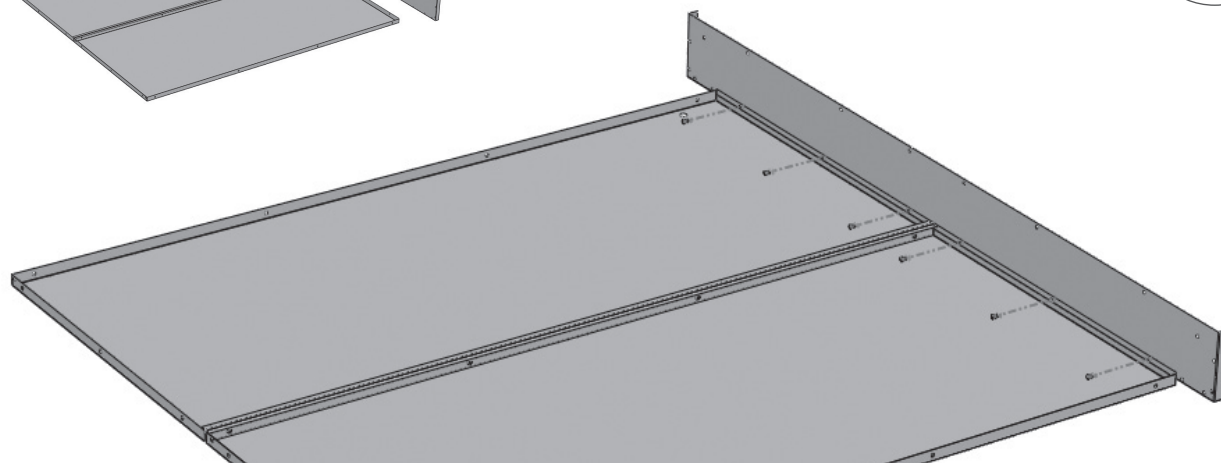
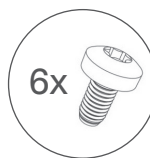
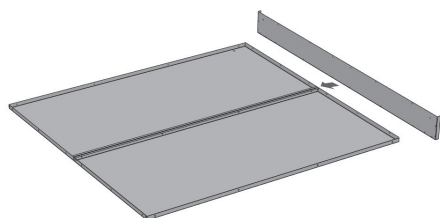

3

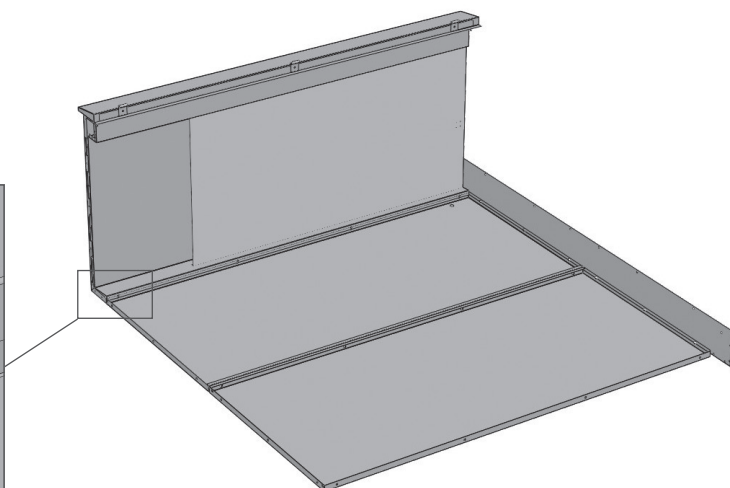
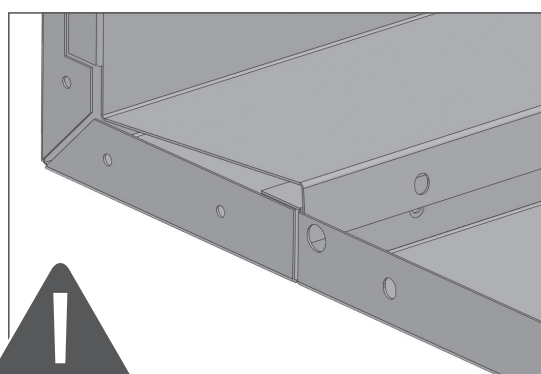

4

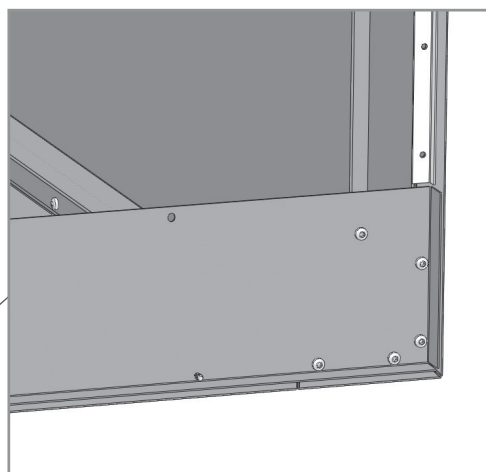
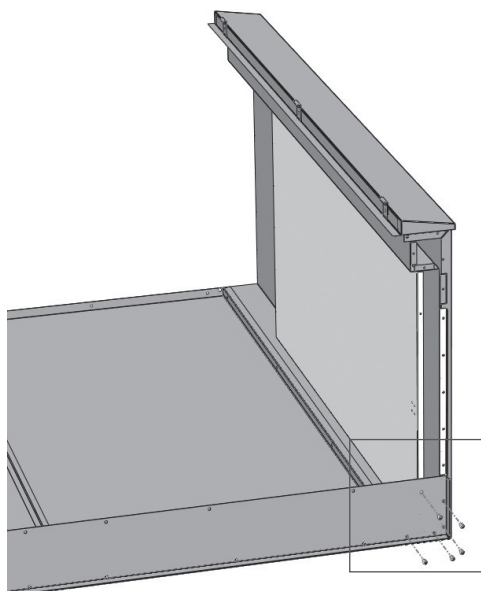

5

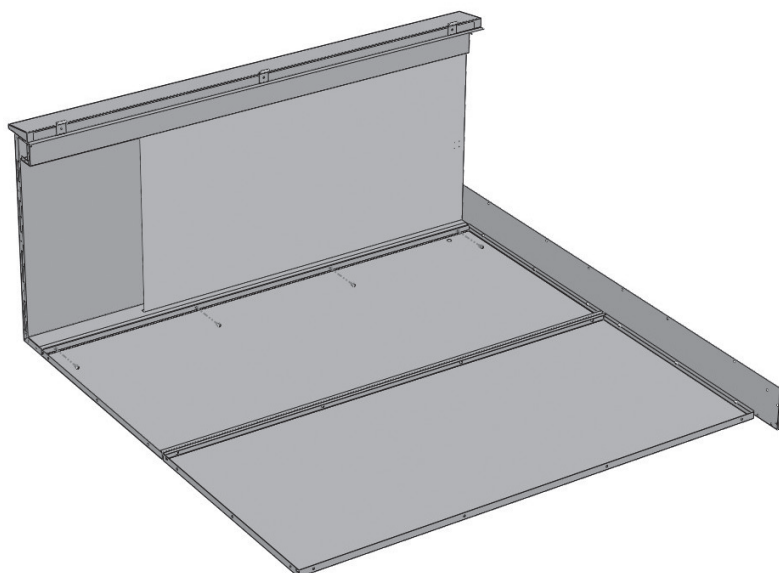

4x



6 (repeat step 3-5)

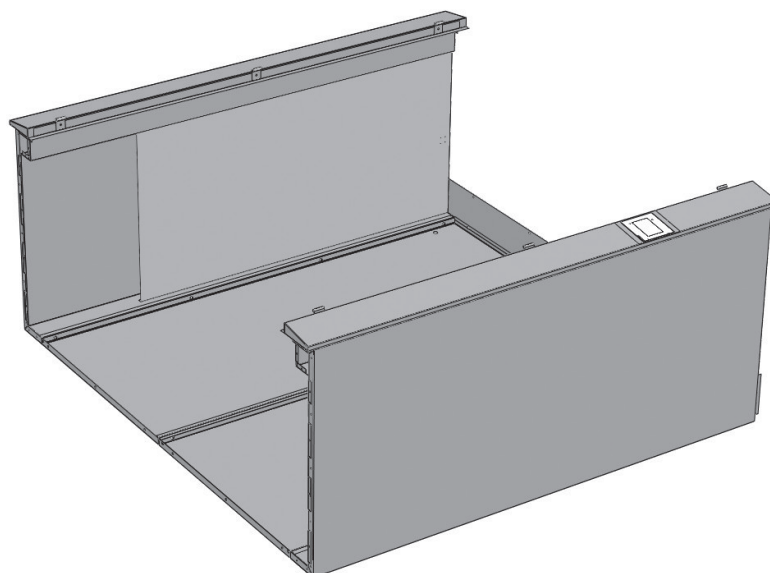

9x



7

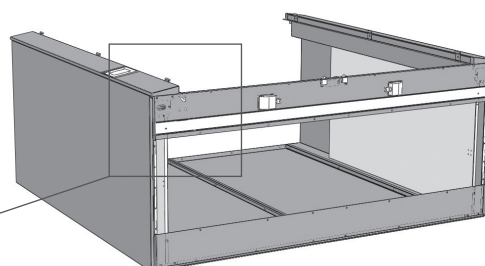
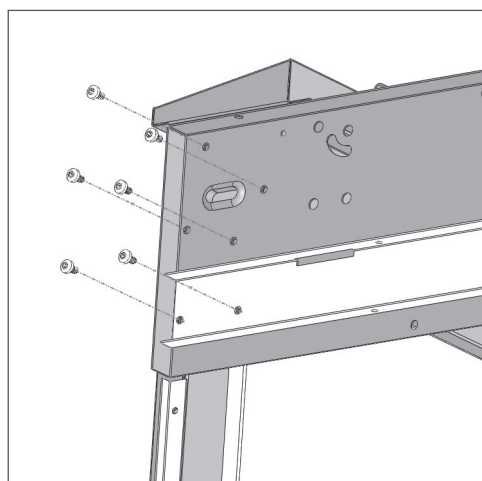

6x



8

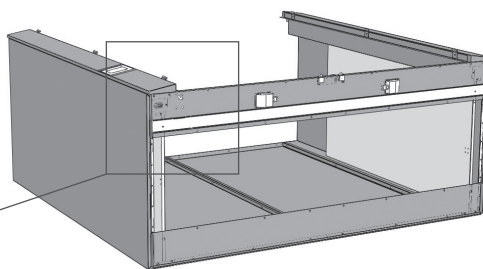
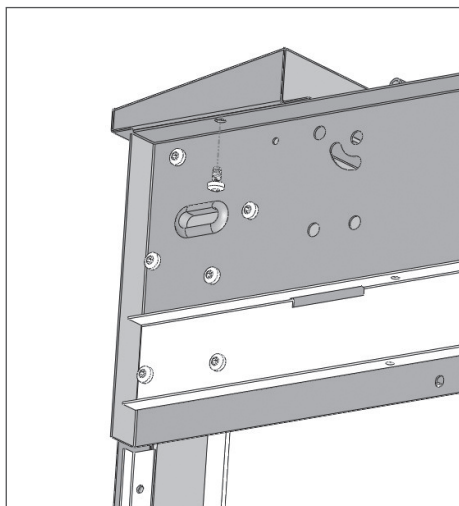

9

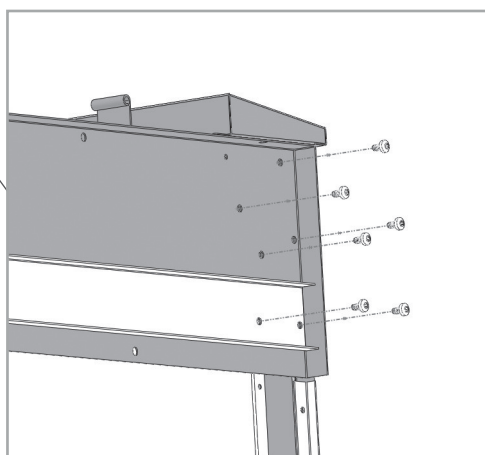
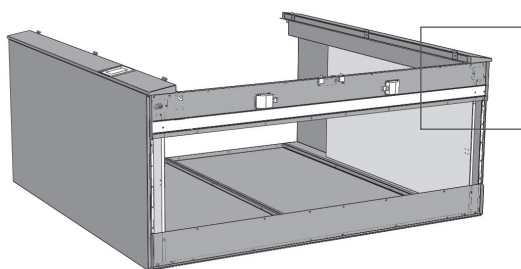

10

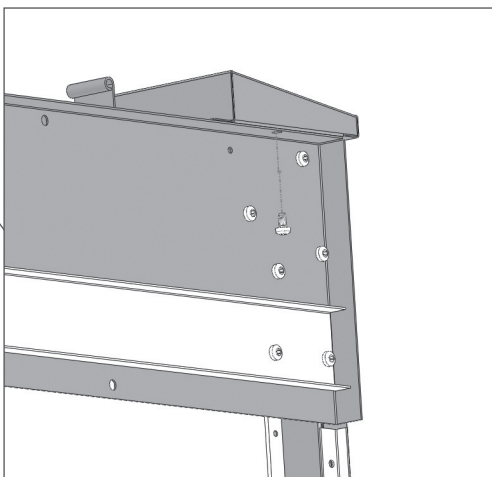
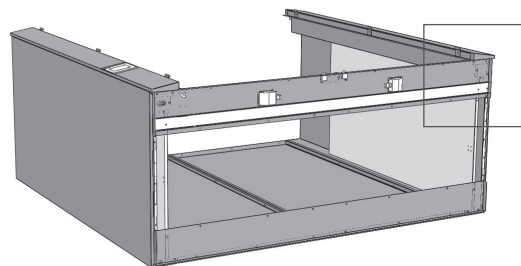

11

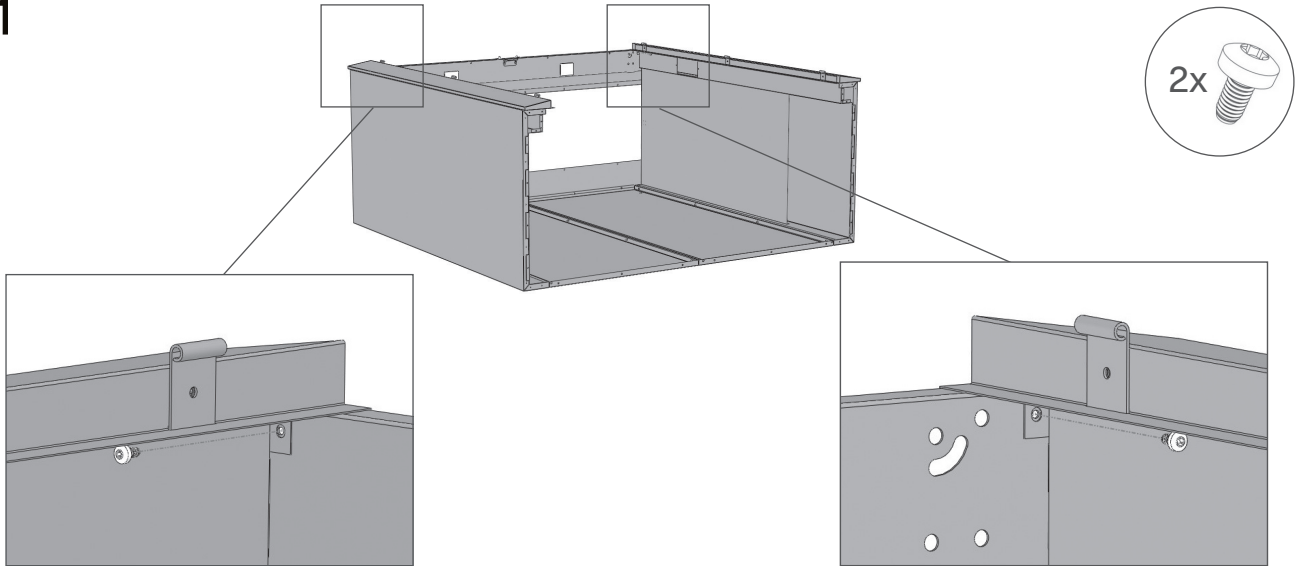

12

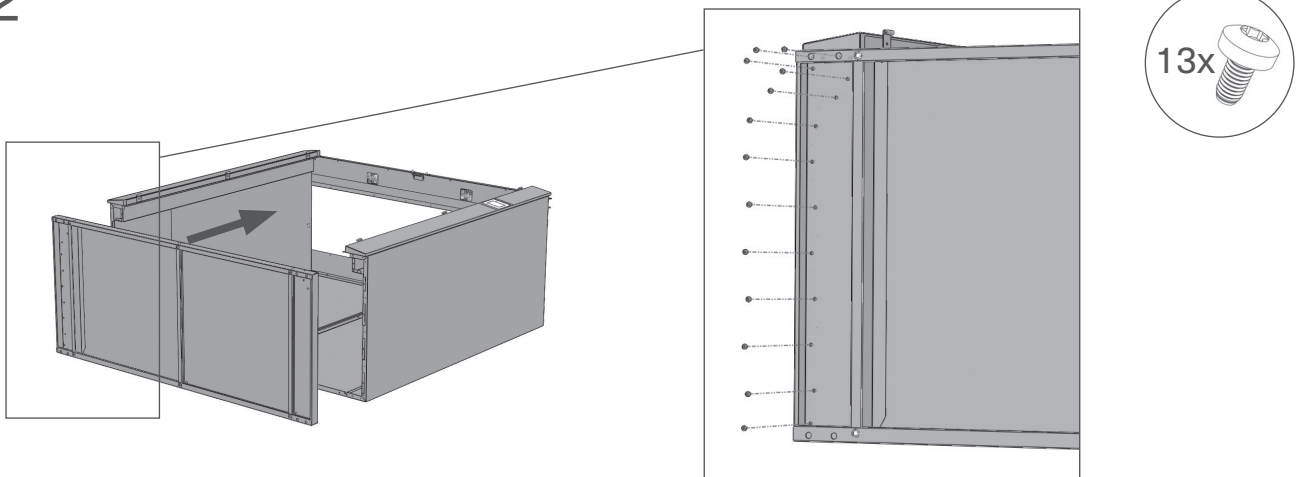

13

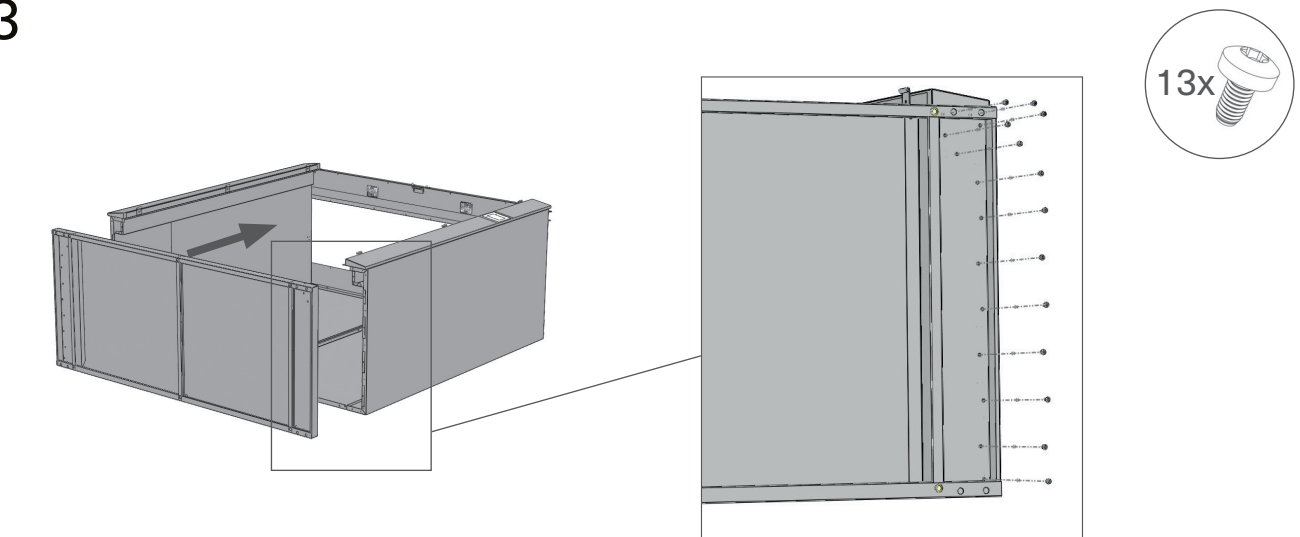

14

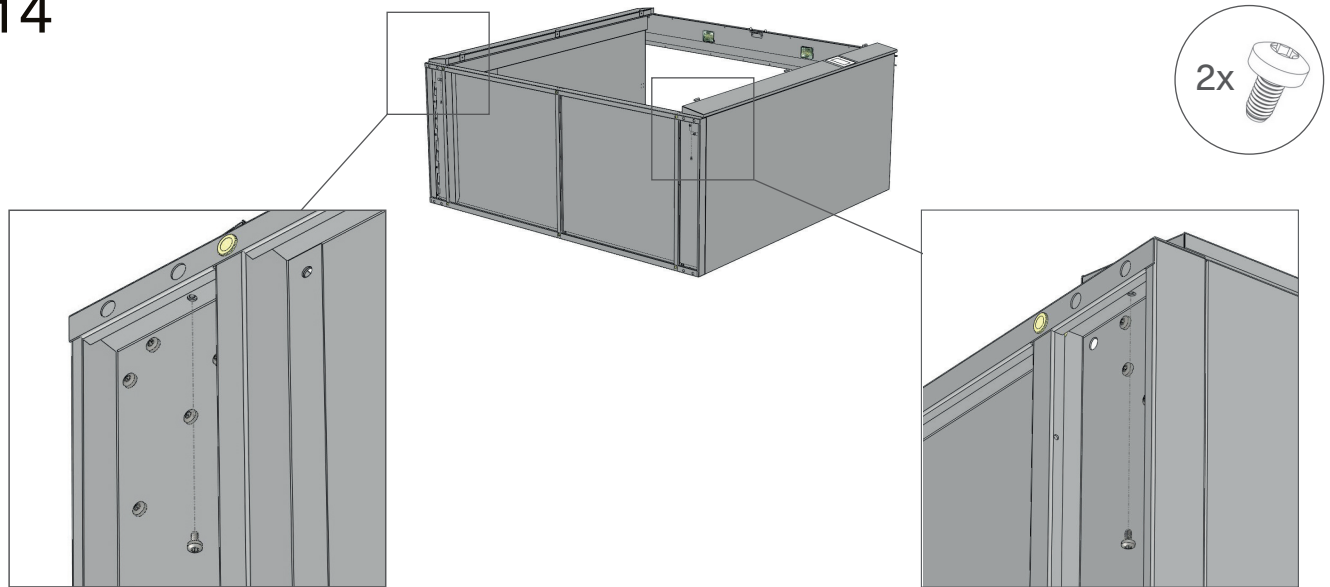

15

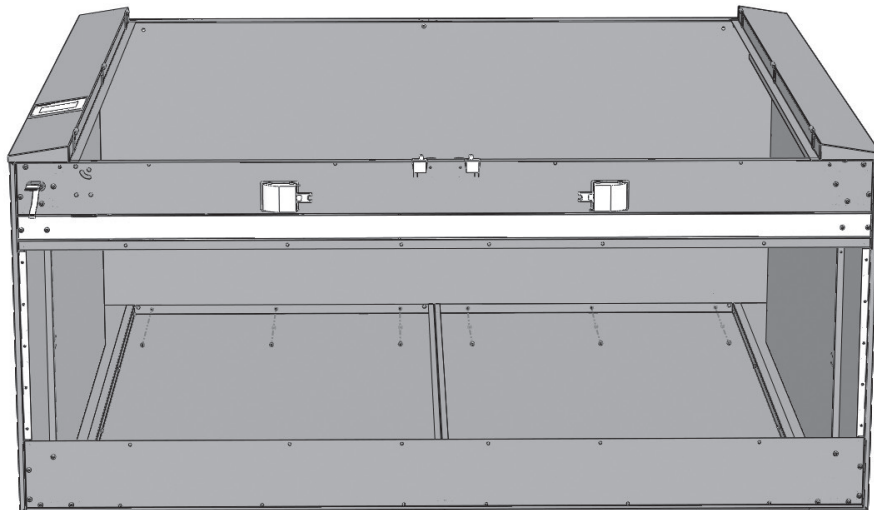

16

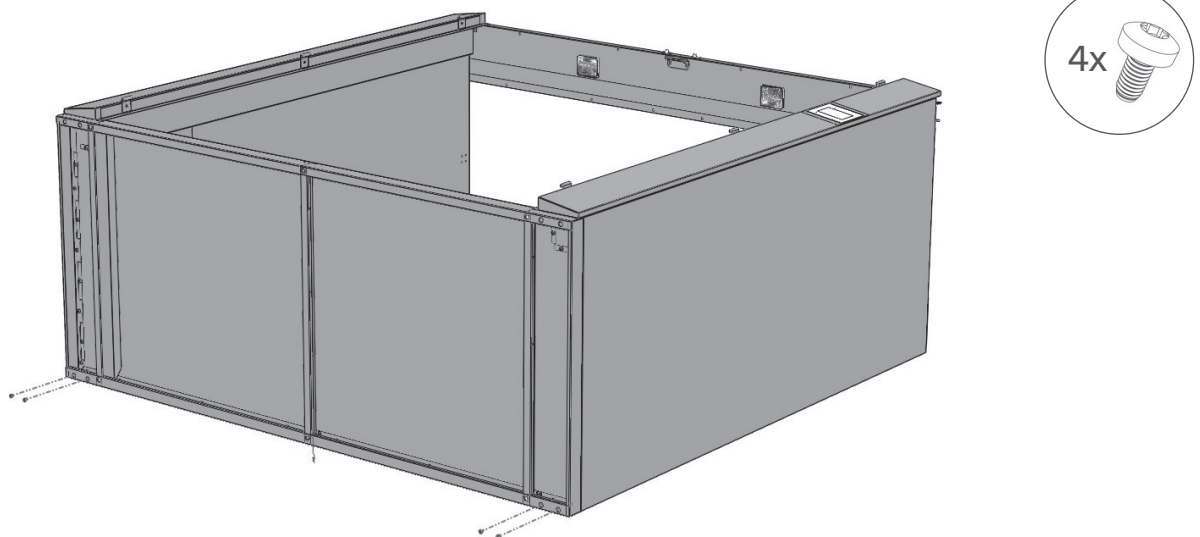

17

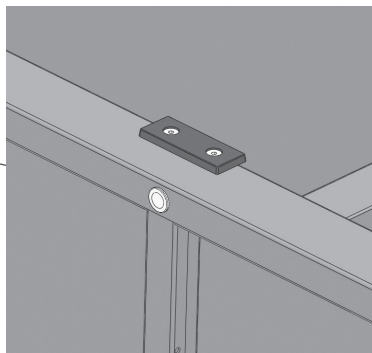
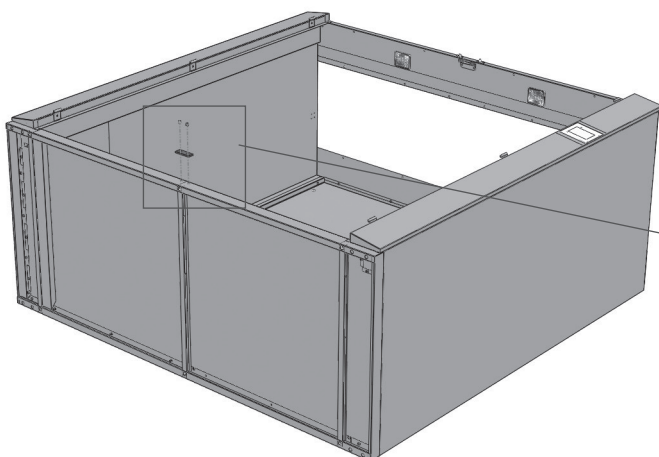

18

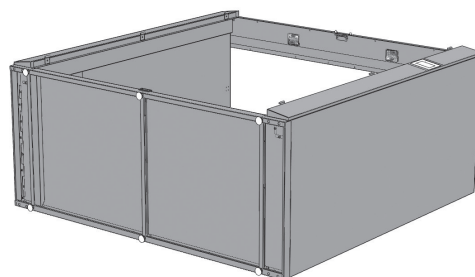
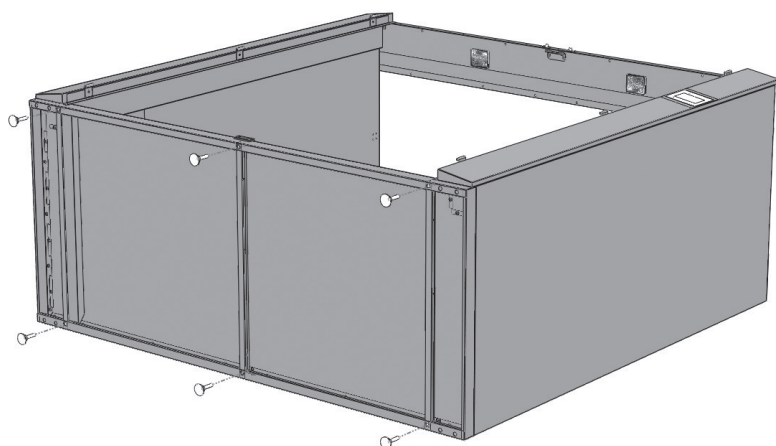

19

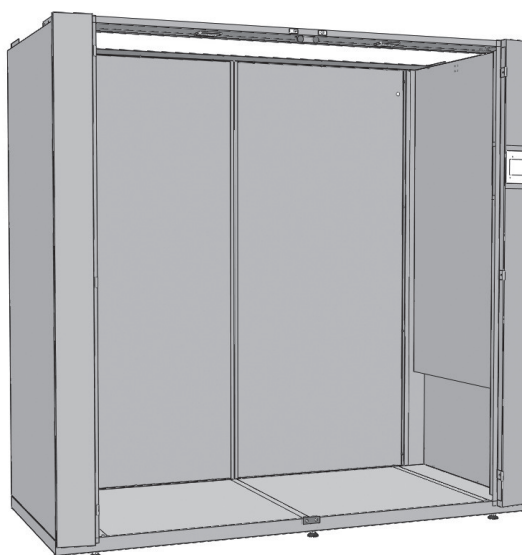
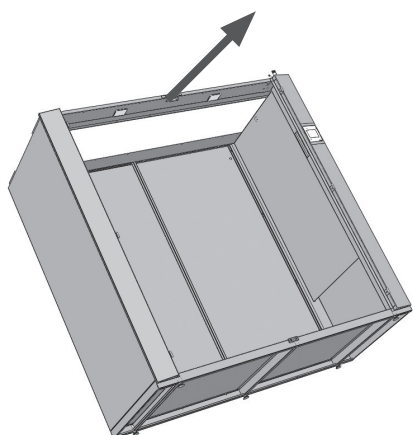

20

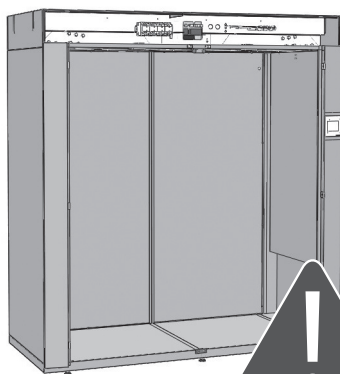
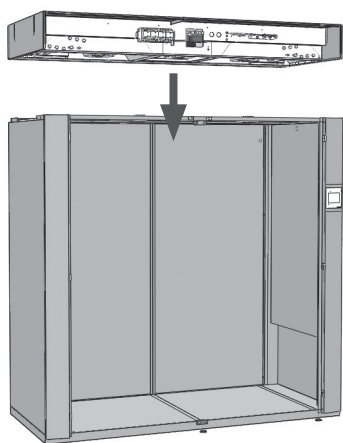
**WARNING**

When positioning the top, make sure no cables get caught between the top and the frame.

21

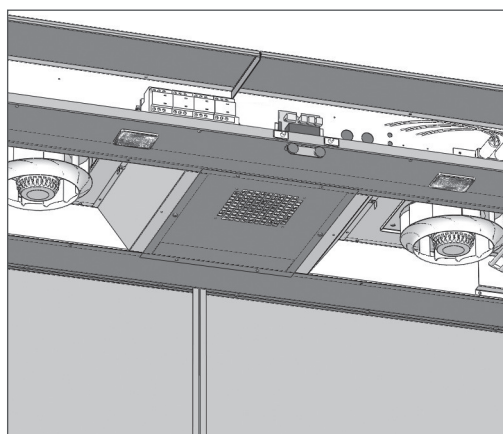
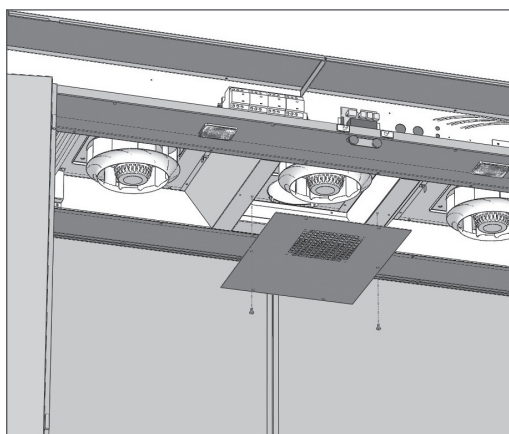

2x



22

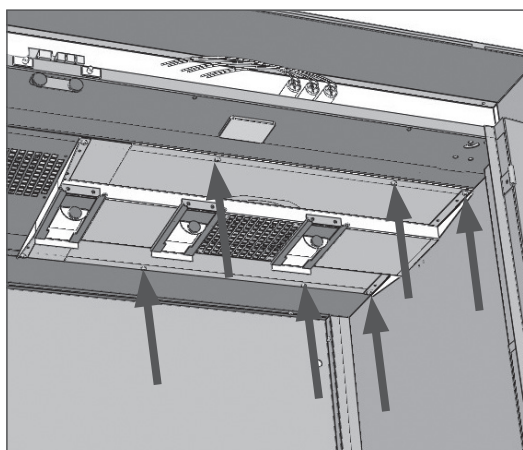
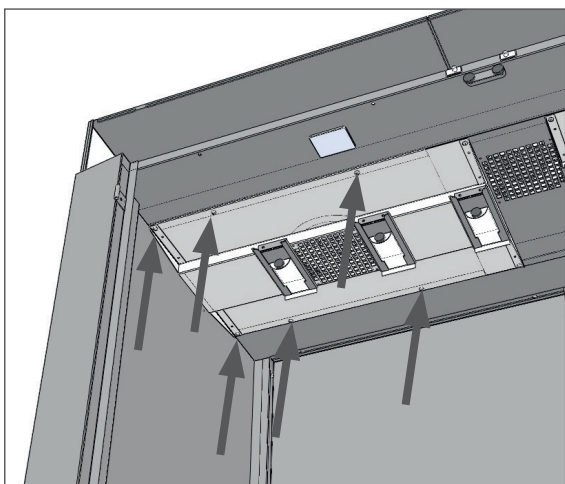

12x



23

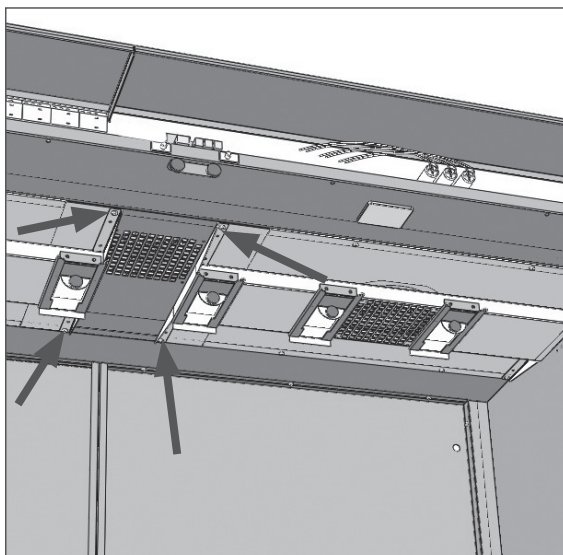

24

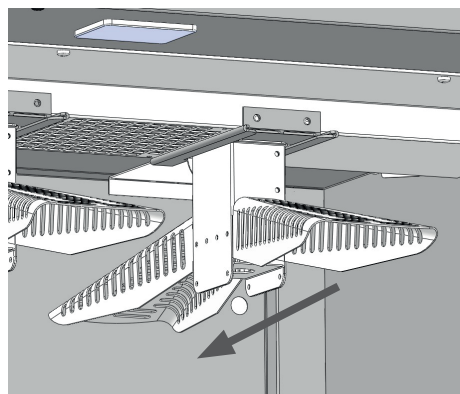
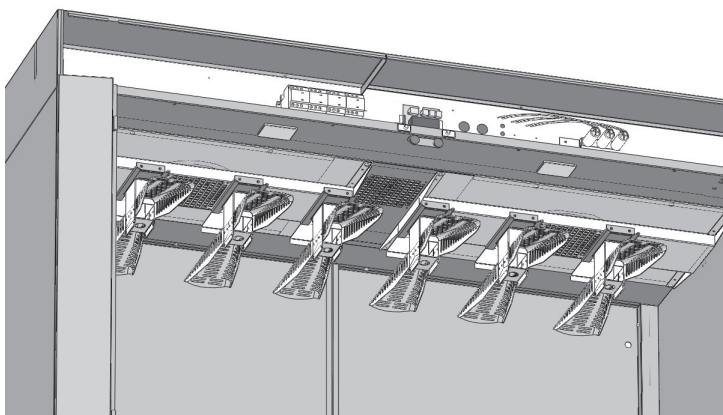

25 Connect the cables

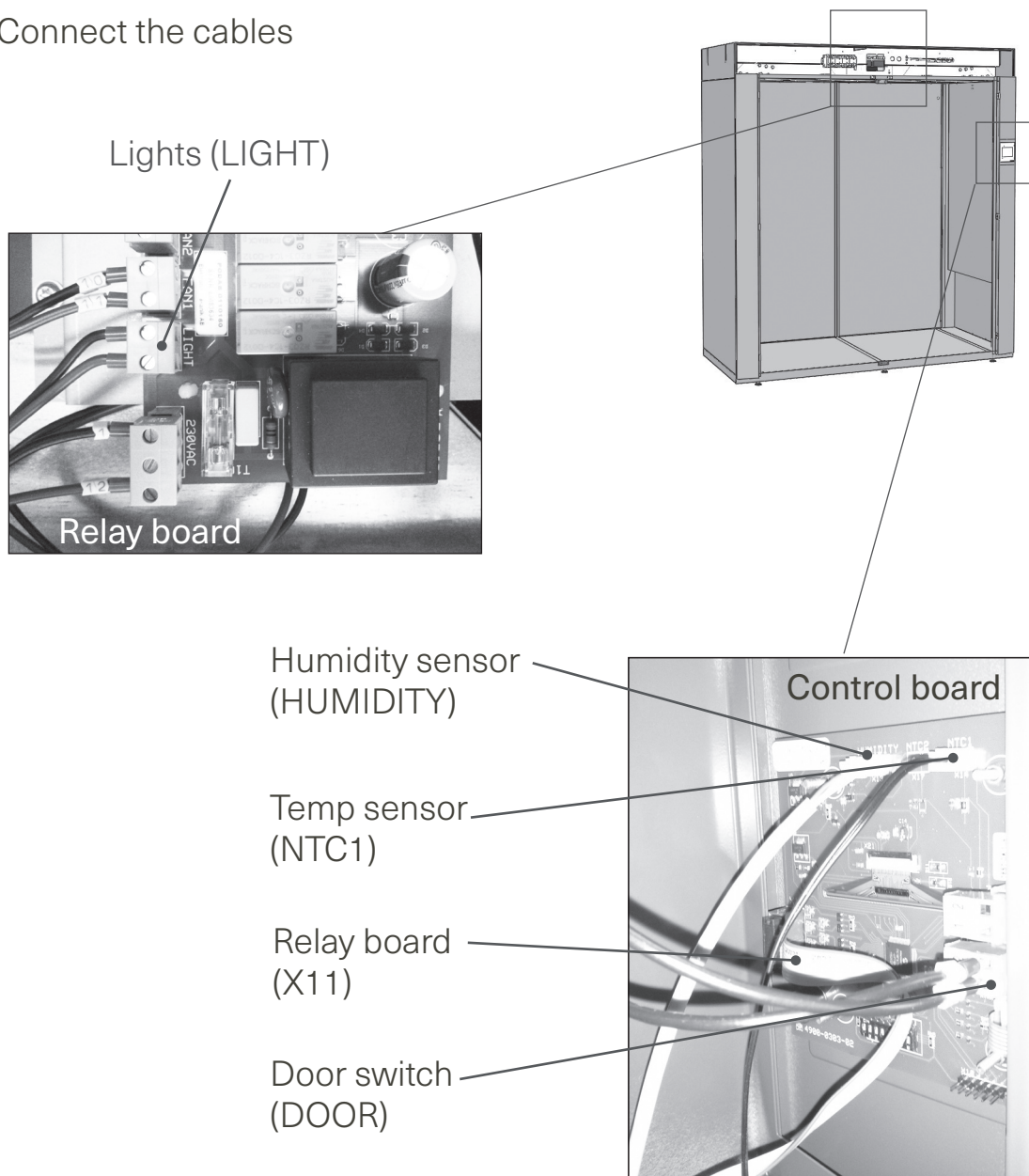

26

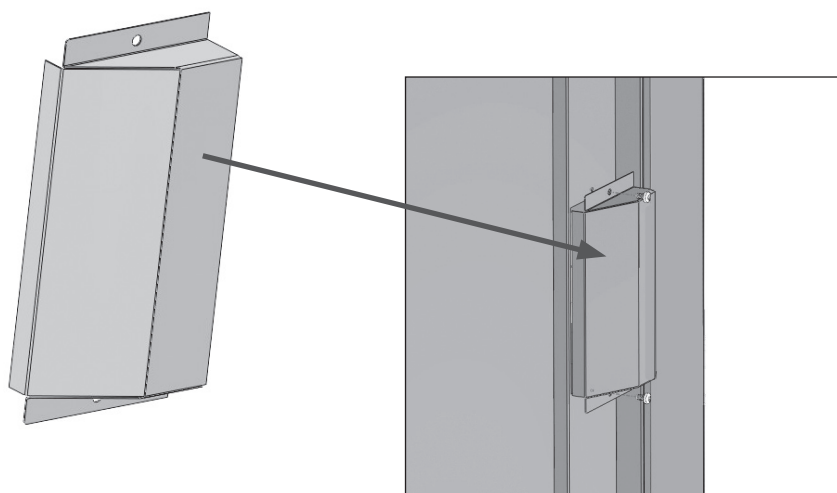

27

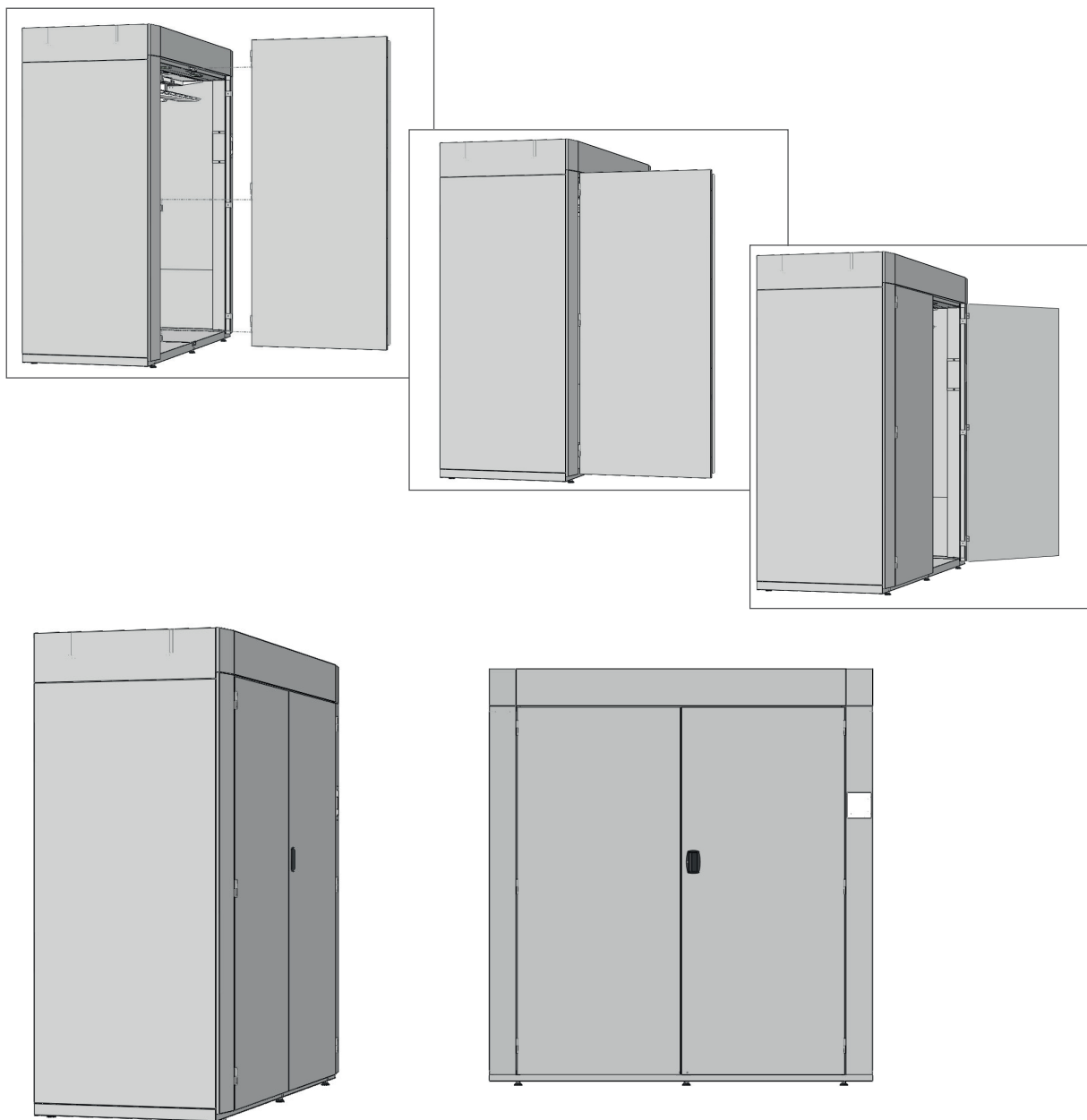

28 To be completed after electrical connection. See page 20 for details.

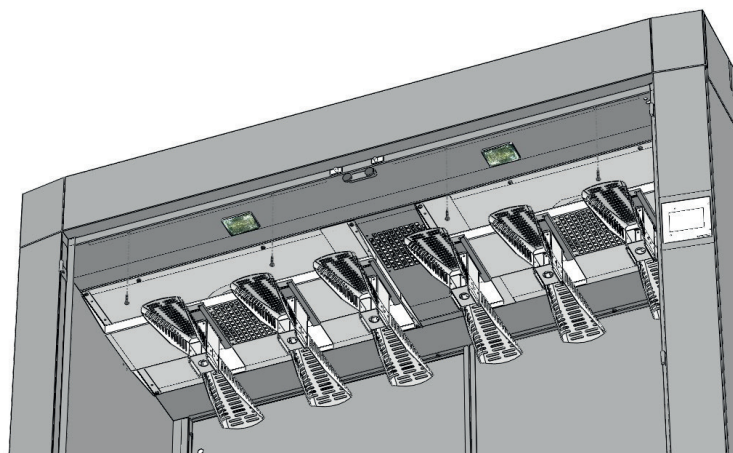
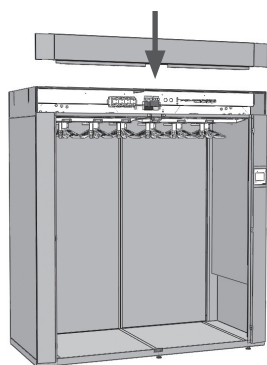

Installation of the cabinet

Step 1: Put the cabinet in place

Place the cabinet with enough space in front of the cabinet and on the sides to be able to open the doors.

The feet of the cabinet can be adjusted from the inside with the help of a Hex key. The feet must stand free on the floor and have an even weight distribution. Use a leveler and control that the cabinet is leveled; horizontally and vertically.

NOTE: We recommend that the cabinet is installed on a firm and leveled floor for the doors to close properly.

Step 2: Fasten the cabinet to the wall

Use the angle irons to secure the cabinet to the wall. The mounting holes are placed at the top of the cabinet. The angle irons can be adjusted to fit the distance to the wall.

NOTE: Please control that the cabinet is leveled and cannot be tilted.

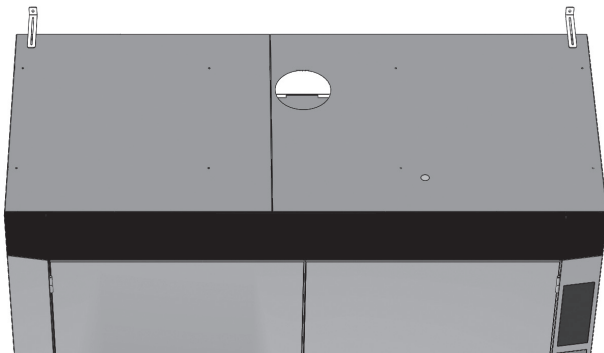

ATTENTION

Never place the cabinet in direct contact with wooden material. Always use the stoppers to prevent the cabinet from direct contact to a wooden wall. Leave a security distance of at least 1.2 in / 30 mm.

WARNING

Cabinet needs to be fastened to the wall for safety.

Step 3: Connect the cabinet to the ventilation channel

For further instructions, see page 21: Requirements for ventilation.

- Do not use ventilation channels made of plastic or foil.
- Place the cabinet so that the ventilation channel is as short as possible.
- Make sure that the ventilation channel is cleaned when a new cabinet is installed.
- Use a 6 in / 152 mm rigid or flexible metal duct to the evacuation connection.
- If you use rigid ducts, it is important that the male connector of the ventilation tube on each section follows the air direction.
- The construction shall be as straight as possible.
- Always isolate ducts that go through non-isolated areas. The condensation makes dust and dirt get stuck in the channel.

NOTE: If the cabinet is not connected according to these recommendations, the warranty is no longer valid.

Step 4: Connect the drying cabinet to the main switch/breaker

To prevent that fire and electric shock appear, the cabinet MUST be connected according to the color codes on the cables. Only an authorized electrician is allowed to install the electrical connection. The cabinet is prepared for one of these electrical connections: (you can see which electrical connection your cabinet is prepared for by looking at the technical sticker inside your cabinet or buy contacting the support number).

- 208/240 V, 3P, 60 Hz
- 240 V, 1P, 60 Hz
- Make sure the front panel is removed before connecting the power cable. If not removed, detach the front panel by loosening four screws underneath (refer to step 28 to locate the correct screws). Gently lift the panel upward to reveal the electrical connections.
- Find the designated marked hole situated at the front end of the top panel.

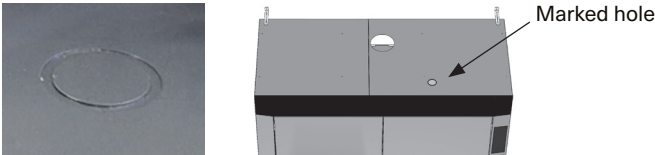

- Punch out the appropriately sized hole that corresponds to the chosen power cable.
- Mount the strain relief within the punched-out hole.
- Insert power cable.

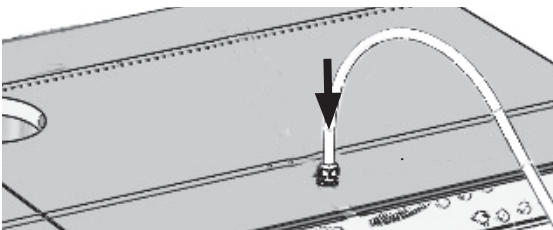

- Connect hot wires and ground to the connection plint (see pictures below)

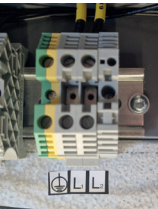

240 V, 1P, 60Hz, 60A
⏏ - ground
L1 - Hot wire 1
L2 - Hot wire 2

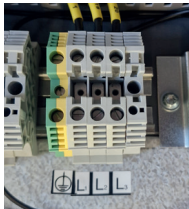

208/240 V, 3P 60Hz, 40A
⏏ - ground
L1 - Hot wire 1
L2 - Hot wire 2
L3 - Hot wire 3

- Tighten strain releif.
- Reattach the front panel (refer to step 28 for guidance).
- The cabinet is now prepared to be connected to the main switch/ breaker.

WARNING

To prevent that fire and electric shock appear, the cabinet MUST be connected according to the color codes on the cables.

It is always the buyer that has the responsibility to check that an authorized electrician makes the electrical connections of the cabinet.

WARNING

To prevent personal injuries, the cabinet shall always be connected permanently through an all pole main switch. Always ground the cabinet!

Also check that the connecting cable has a strain relief bushing. If not, there is a risk that the cabinet will be live.

Step 5: Control that the heating relay is working

Shut the doors and start the cabinet, after about 3 seconds you can hear when the heat relays hit. Wait a couple of minutes and control that the outgoing air channel becomes warm.

If the outgoing air channel does not get warm, go back to step 4 and control that the electrical connection is installed correctly.

WARNING

The manufacturer disclaims all liability if the electrical connection has not been carried out in the way described in this use and care manual.

WARNING

If the power cord is damaged for any reason, it must be replaced.

Requirements for ventilation

WARNING

A drying cabinet produces inflammable dust. To minimize the risk for fire, the evacuation of the cabinet must be connected to a ventilation channel that evacuates the air.

Never let the evacuated air into a room or a surrounding where there is a risk for ignition.

Do not use ventilation channels in plastic or fire dangerous material.

Ventilation channel – choice of material

Ventilation channel, ducts, connections etc are not included.

The ventilation channels shall be at least 6 in / 152 mm in diameter and should not have channels or similar on the inside.

We recommend that the ventilation system is built with rigid metal ducts for best result. Flexible evacuating ducts for drying cabinets can also be used.

NOTE: Never use flexible ducts through walls or other covered areas.

NOTE: Do not screw or nit the ventilation channel, so that the screws will come through the inside of the pipe. This construction will gather dust and impaire the cabinet's performance.

The channel shall always be separated from the other ventilation in the house.

Requirements for incoming air

In order to make the cabinet work properly, it is very important that there is enough incoming air in the room. The incoming air must be at least 235.4 cfm / 400 m³/h.

If the cabinet is placed in a room where the incoming air is not enough, we recommend that you install an air exchanger.

Ventilation channel – design

IMPORTANT: Always make the channels as short as possible.

NOTE: If a drying cabinet is installed in an old ventilation channel, please clean the channel properly.

In order to make the cabinet work properly, the incoming airflow must be enough. The amount of evacuated air per hour is depending on how high the pressure fall in the ventilation channel is.

Material, the design and the length of the channel have a large impact on the air flow. In order to get the best possible performance, the pressure fall shall be as low as possible.

When the air is transported through the channel, it is exposed to different kind of resistance. Factors that give a low pressure fall:

- Smooth inner walls on the pipe
- Large diameter on the pipe
- Short length on the pipe
- Few curves
- Few angels (90 degrees)

Evacuated amount of air and pressure fall

In order to get this drying cabinet to work properly, the ventilation channel shall be designed to get an out coming air flow from the cabinet of about 210 cfm / 350 m³/h. When the cabinet is installed to an existing channel system, the cabinet can be calibrated to optimize the air flow.

In order to gain this air flow, the pressure fall must not exceed 210 Pa. By an airflow of 210 cfm / 350 m³/h and a diameter of the pipe of 6 in / 152 mm, this corresponds to a straight, smooth ventilation channel of 153 yd / 140 m.



Pressure fall estimation

The counter pressure in the ventilation channel can be measured with a pressure meter. The measuring point shall be placed by the cabinets evacuating outlet.

In order to estimate the pressure fall without meter equipment we recommend the following:

- Identify the ventilation channel's incoming components in the air flow direction.
- Check the part pressure fall for each component in the table.
- Calculate the total amount of pressure fall by adding each parts pressure fall.

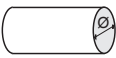
The table shows the most common components in a ventilation system. The information shall be considered as approximate data. For more information, contact the manufacturer of the parts of the system. Please note that the data in the table is for an air flow of 210 cfm / 350 m³/h.

Component		Pressure fall	
Circular channel	ø, in / mm	Pa/m	
	6 / 152	1,5	
Pipe bends 90°	ø, in / mm	r, in / mm	Pa/bend
	6 / 152	6 / 152	4

Example: 10 m / 10.9 yd long 152 mm / 6 in channel with 3 pipe curves which gives an estimated pressure fall of

$$(10 \times 1,5) + (3 \times 4) = 27 \text{ Pa.}$$

Decrease the outgoing air flow

The cabinets function and automatic programs are optimized for the recommended air flow of 210 cfm / 350 m³/h. If the design of the ventilation is made so that evacuated air flow exceeds 210 cfm / 350 m³/h, the evacuation can be throttled with help of a damper. Contact a ventilation expert in order to find a proper solution for your ventilation.

User manual

Fill the cabinet

To get the best drying result: try to dry the same type of PPE suits at the same time. Distribute the clothing evenly in the cabinet. If less than six suits are dried, remove the hangers not used. The dampers are closed automatically.

Close the doors

The drying cabinet will not start until the doors are completely closed.

Keypad

1. Display
2. Program select*
3. Increase time
4. Start/stop

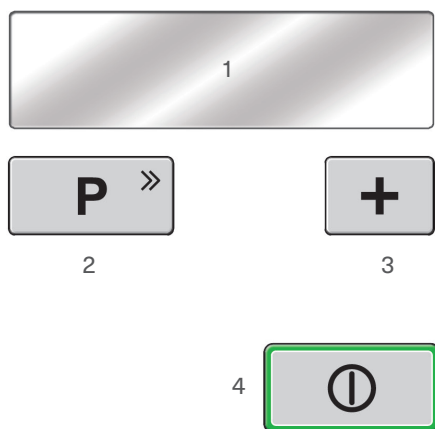

* Fast forward during drying.

Select program

Change program by pushing program select (button 2). The symbol of the chosen program is highlighted and the program name is showed on the screen.

Start program

Push start/stop button (button 4) in order to start the drying cabinet.

Pause program

To pause a working program, open the doors. Close the doors and push the start button to continue drying.

Cancel program

To cancel a working program push the start-/stop button.

<h2>CAUTION</h2>
<p>If a program is interrupted before the cool down has finished, the ceiling of the cabinet could be very hot.</p>

Cool down

All programs, both timed and automatic, have a cool down phase of 15 minutes. During cool down the textiles are reconditioned and the drying cabinet is cooled down.

Standby

If no button has been pushed and the door hasn't been opened or closed within 4 minutes, the display is turned off. The diode and the lamp in the cabin is also turned off if the door is open.

Automatic programs

The drying cabinet is equipped with the function HTS – Humidity Tracking System. This function is activated in the automatic program mode. The drying time adjusts to the laundry in the cabinet and is controlled by a humidity sensor.

The cabinet has three different programs:

- 1 MEMBRANE / LINERS / SHELLS**
Protective suits with membrane / liner / shell fabric. Reactivation of impregnation at the end of the program.
- 2 WITHOUT MEMBRANE / MISC. GEAR**
Protective suits without membrane fabric e.g. suits with padding. Reactivation of impregnation at the end of the program.
- 3 STATIONWEAR**
Station and sportswear.

Reactivation of impregnation

The programs Membrane/Liners/Shells and Without Membrane / Misc. Gear have a unique function. By the end of the drying cycle the cabinets goes into reactivation mode. During 30 minutes the evacuation of air is stopped and the temperature is maximized. This hardens the impregnation of the suits.

Select drying time manually

- TIMED DRYING**
The cabinet has a timed drying program for the user who prefers to set the time manually.

Set the time

The default drying time when entering Timed Drying program is 0:15h. Increase the drying time with the plus button. The drying time can be increased to a maximum of 5:00h.

Maintenance

Take good care of the cabinet

Only use a damp cloth with a mild detergent when cleaning the cabinet.

Never use solvent to clean the display.

Ventilation system

Loosen the ventilation pipe on the cabinet every year and clean if necessary around the evacuating channel.

IMPORTANT: Always switch off the electricity before starting to work with the cabinet.

Inspect with set intervals the complete ventilation channel; don't forget the outer wall. There can easily be leaves and other rubbish that chokes.

We recommend that you once a year, take down the service doors and vacuum clean around the fans and elements.

Keep your cabinet efficient and economical

- The ventilation channels shall be as short as possible.
- If possible, dry the same type of textiles at the same time.

WARNING

The front panel should only be opened by an authorized electrician.

CAUTION: DISCONNECT FROM THE SUPPLY BEFORE OPENING THIS COVER

Warranty

Customer care

If you have encountered a problem that you cannot resolve, please contact your dealer..

www.podab.com
+1 (800) 683-4873
support.na@podab.com

When making contact, provide the details on the serial number plate. Include the product number (1) and the serial number (2).

Service after expiration of limited warranty

For information about obtaining parts and labor after expiration of this Limited Warranty or arising outside the scope of this Limited Warranty, please contact your dealer.

Access our full limited warranty details and register your product on our website here:



Notes

Notes

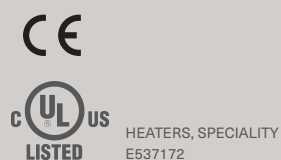

PODAB Inc.
Tel: +1 (800) 683-4873
E-mail: info.na@podab.com
Service e-mail: support.na@podab.com
www.podab.com

